

INSTALLATION INSTRUCTIONS FOR Plyboo Stiletto® CLICK-LOCK FLOATING FLOORS

A. INTRODUCTION

PLEASE READ THE INSTRUCTIONS COMPLETELY BEFORE PROCEEDING WITH THE ACTUAL INSTALLATION.

To ensure that you have sufficient material on hand, calculate the total area of the room and add a minimum of 5% To 10% additional material to allow for special cuts and possible errors.

SETUP AND SITE PREPARATION:

1. Permanent HVAC should be on and operational and maintained between 50-80 degrees F with relative humidity of 35%-65% for a minimum of 14 days prior to installation, and after installation.
2. At a minimum of seventy-two hours prior to installation, place the flooring boxes on a flat, even surface in the center of the workspace. This allows the bamboo flooring to acclimate to the environment in which it will be installed. Open the cartons during this period.
3. Inspect each plank before installation. If you find planks with visible defects, please contact us for replacement. The manufacturer cannot accept responsibility for flooring installed with visible defects.
4. Flooring should not be delivered to the site until the building is fitted with exterior windows and doors, and all "wet trade" work (painting, dry wall, tile work, etc.) has been completed. Subfloor moisture levels must meet the manufacturer's recommendations.
5. Gutters, down spouts, and exterior grading should direct drainage away from the structure's foundation.
6. Basements and crawl spaces must be dry and well-ventilated. A 6-8 mil polyethylene moisture barrier must cover the ground of all crawl spaces; seams must be overlapped and taped.

B. PRE-INSTALLATION PLANNING REQUIREMENTS

1. Decide what direction the flooring will be installed. Planks should be installed perpendicular to floor joists.
2. The subfloor must be level or the floor could flex, causing the boards to squeak. An uneven subfloor may weaken the locking system over time, causing gaps or loose boards.
3. Like all wood floors, a floating floor expands and contracts with seasonal changes. DO NOT put fasteners (nails, screws, etc.) through the floor or pinch the floor under doorways. This can cause the floor to pull apart or buckle because it cannot move freely.
4. Leave a 3/4" space around the perimeter of the room(s) and all vertical objects (columns, cabinets, stairs, etc.) to allow the floor to expand and contract seasonally.
5. Based on the width of your planks, pre-plan the number of rows that will be required to finish the installation. The final row will normally be narrower and have to be trimmed length-wise. You may want to trim both the first and the last rows to balance the installation. If possible, the last row should be wider than 2". If a row must be narrower than 2", carpenter's glue is recommended to secure the narrow board to the adjoining full row.
6. Remove any base, shoe molding, or interior threshold. These can be replaced after the floor has been installed. *Undercut door jambs to allow for expansion or free movement.*
7. Maintain a relative humidity level between 35%-65% to perform optimally. A humidifier or dehumidifier may be required in some environments to achieve these humidity levels.
8. It is considered normal with a floating floor to use putty to fill small gaps or to correct minor imperfections. When using putty on a satin, low-sheen finish, apply putty with a plastic putty knife. Remove any excess immediately with a soft cloth to prevent gloss up of finish.
9. Install the planks parallel to the longest wall or in the same direction as incoming light. In areas longer than 30 feet (10m) or wider than 24 feet (8m), an expansion gap and T-mold should be used to allow for proper movement of the floor.

IMPORTANT: Bamboo is a natural material and some color and shade variation should be expected. **Always work from several boxes at a time to allow for color matching and sorting of the planks for best appearance.**

We recommend not installing in a full bath or in other areas where flooring might come in direct contact with water or excessive amounts of moisture.

C. PREVENTATIVE MAINTENANCE

To ensure satisfaction with your Plyboo click-locking floating floor, and to extend its beauty for years to come, we recommend the following preventative maintenance suggestions.

1. Install floor protectors on furniture legs to protect against scratches and dents. These furniture pads should be made of soft, non-staining material (e.g., felt or nylon pads).
2. Do not drag or roll furniture, or other heavy objects, across the floor. Rollers from refrigerators, televisions,
3. stereos, etc., can damage the floor. First lay 1/8"-1/4" plywood on the floor and roll the appliance or furniture piece over the plywood.
4. Sweep and vacuum floor regularly.
5. Avoid sand and grit build-up. Use protective mats or rugs at doorways and areas of heavy traffic. However, never use latex or rubber backed mats or rugs; they can discolor the floor.
6. Place protective pads under chairs with wheels.
7. Use only recommended cleaning products such as the Bona Floor cleaning kit.
8. Never wet-mop your floor. Never wax or use oil-based products on your floor.

Tools needed:

1. 3/4" wood or plastic wedges
2. 6-8 mil polyethylene moisture barrier
3. Titebond Tongue & Groove Flooring Glue (16oz per 500 sqft estimated, coverage may vary)
4. Plyboquiet MMS underlayment
5. Measuring tape
6. Safety glasses
7. Chalk line
8. Square edge
9. Circular or hand saw
10. Pencil
11. Jamb saw
12. Wood chisel

General subfloor requirements:

- a. All subfloors must be flat to 3/16" per 10' radius. If subfloor prep is required, "high spots" should be sanded or ground down and "low spots" should be filled and leveled with a high quality leveling compound.
- b. All subfloors must be clean and free from debris and contaminants.
- c. Nail or screw any loose areas to prevent squeaking.
- d. This floor can be floated over any structurally sound, flat, dry subfloor.
- e. Floor damage caused by poor subfloor preparation is not covered by product warranty.

D. SUBFLOOR MOISTURE REQUIREMENTS

ALL SUBFLOORS MUST BE: Dry and remain dry year-round. An appropriate polyethylene moisture barrier, of no less than 6-8 mil. in thickness, should be used between the subfloor (including for example concrete or wood subfloors) and the pad system being used to prevent moisture transmission from the subfloor to the installed flooring.

Moisture content of wood subfloors must not exceed 12%, wood flooring moisture content must be within 3% of wood subfloor moisture content, or 2% when installing over radiant heat, Concrete must not exceed 3lbs per Calcium Chloride Test (test method ASTM 1869-89) or 2 lbs. when installing over radiant heat, structurally sound.

a. Radiant heating subfloors

To prevent radiant floor heating systems from altering product performance, please consider the following recommendations.

- i. Follow the instructions of the heating system manufacturer carefully, and make sure that the subfloor surface temperature is even and does not exceed 75 °F. Excessive heating can cause the flooring to show gapping. Hot or cold spots within the system alter floor performance.
- ii. The heating system should be operational and running for a minimum of 14 days prior to installation of the flooring. Three to four days prior to installation, the system should be reduced or shut off. At the time of installation, the subfloor should be between 62 - 68 °F, or as recommended by the heating system manufacturer.
- iii. The radiant heat setting should be adjusted gradually, at increments of 5 °F and not exceeding an overall temperature of 75 °F. Heat settings should not vary more than 15 °F seasonally.

b. Floating installation

- i. If you are working over concrete and using an underlayment that does not have a vapor barrier attached, loosely lay a 6-8 mil poly vapor barrier sheeting with the seams overlapping one another by 8" and tape with

- clear packaging or duct tape. The sheeting should also lap around the perimeter of the room and 4" up on the walls. This can be trimmed off after the base molding are installed.
- ii. Roll out PlybooQuiet MMS underlayment perpendicular to the intended direction of installation of the flooring planks, utilize a thinner tape to adhere seams. Avoid creasing or folding the PlybooQuiet MMS underlayment.
 - iii. Begin laying the floor from the left corner of the room. ALL BOARDS SHOULD BE INSTALLED WITH THE TONGUE-SIDE FACING THE WALL. (See Figure 1)
 - iv. Begin installing the first row by laying a board down flat on the subfloor. (Figure 4) Align the end of the second board with the first and snap end-locking system together by simply pushing it straight down on top of the first board. Repeat this step to install the remaining boards in the first row. Cut the last board in the row to the remaining length or use an end board that was supplied in the carton. If leftover piece is 12" or longer, use it to begin the next row. (Figures 2 and 3)
 - v. Insert spacers between the first row and the wall in order to maintain the appropriate amount of expansion space around the perimeter of the floor.
 - vi. You cannot force the boards together. If the boards are not lying flat, they were not evenly aligned during engagement. Start this step over. Ensure the edges of both boards meet evenly by applying equal pressure while rotating the board down.
 - vii. Continue installing the second row and cut the last board to size just as you did the first.
 - viii. Install the third row in the same manner described above. Once three rows have been installed, re-check the spacers to ensure they are tight against the wall. If necessary, adjust the floor to ensure the installation is square.
 - ix. When working under doorjamb or toe kicks of cabinets, there will not be enough clearance to achieve the 45° angle required to engage the end-locking system. It will be necessary to cut away the tongue portion of the sides using a wood chisel and then glue the boards together using Titebond Tongue & Groove Flooring Glue.
 - x. The boards in the last row will need to be cut to the necessary width. Remember to allow appropriate expansion space between the last row and any vertical surface it adjoins.
 - xi. To mark the first row correctly, place the last board on top of the last row installed with an offset of approximately 3/4". Take a scrap piece of flooring and remove the locking device (tongue). Use it to mark the board to the correct width and contour of the wall.
 - xii. After the flooring is completely installed, remove the spacers, install moldings, and thoroughly clean the floor. Never cover a newly installed floor with plastic; always use a breathable material such as craft paper or cardboard. If a vapor barrier has been used, use finishing nails to attach the baseboard through the plastic membrane sticking up from the floor.

Baseboards: do not fasten the floor in any way. This will prevent the floor from moving freely. The 3/4" expansion space must be maintained underneath the moldings. Finish vertical spacers with a silicone sealer.

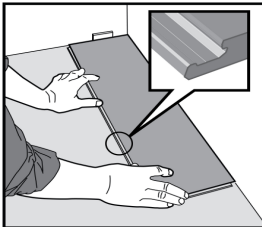

Figure 1.
First plank, first row.
 Tongue side against the wall, groove side facing out.
 Later, after the third row is installed, you can easily position the flooring against the front wall with a distance of approximately 3/4".

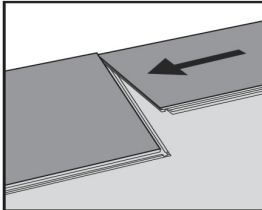

Figure 2.
Second plank, first row.
 Place this plank tight to the short end of the first one.

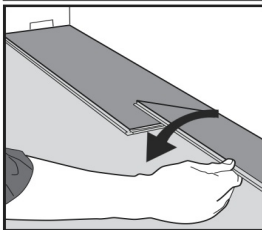

Figure 3.
 Fold down with a single movement.

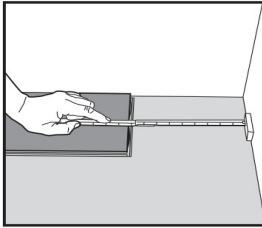

Figure 4.
At the end of the first row, cut the board to fit the remaining length. If the leftover piece is 12" or longer, use it to start the next row. Insert 3/4" spacers.

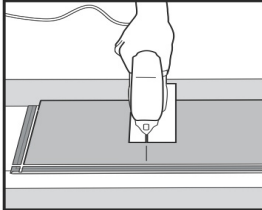

Figure 5.
Cut with a jigsaw face-down, or cut with a hand saw face-up.

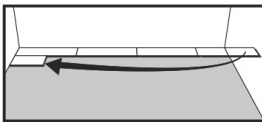

Figure 6.
Second row.
Stagger end joints of adjacent rows a minimum of 12". Once three rows have been installed, re-check the spacers to ensure that they are tight against the wall. Adjust, if necessary, to ensure the installation is square.

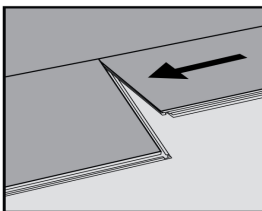

Figure 7.
General; distances between short ends.
Minimum distance between short ends of planks in parallel rows should be 12".

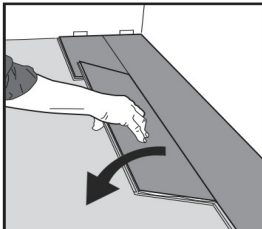

Figure 8.
Second plank, second row.
Place the panel **tight** to the short end of the previous panel and fold down in a single movement.

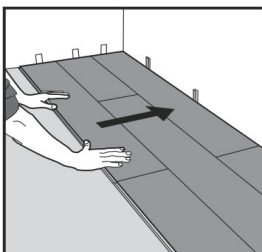

Figure 9.
After 3 rows.
Re-check the spacers to ensure that they are tight against the wall. If necessary, adjust the floor to ensure the installation is square.

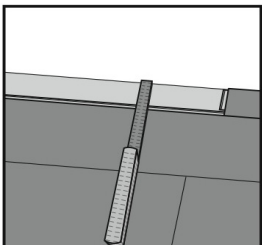
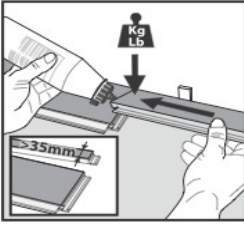

Figure 10.
Last and/or first row.
Allow for proper expansion against the wall or any vertical surface. The last row will need to be cut to the necessary width (2' or wider). Cut the panels length-wise and glue the narrow boards to the adjoining full row.

For panels narrower than 2"
Last and/or first row.



Join panels at their ends by gluing the joint with floating floor adhesive.

Last row or under cabinets

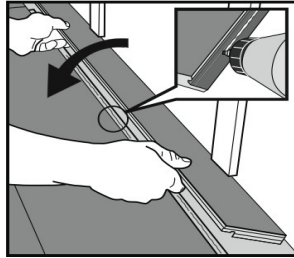
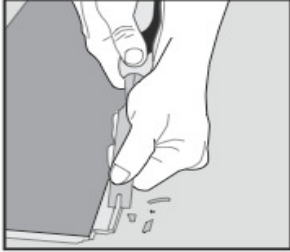

Cut off the locking element with a chisel and use floating floor adhesive on the adjusted strip; push the planks horizontally together.
If necessary, put some distance between the last panel and the wall in order to keep the planks together during the curing time of the glue.